

# SURVEYOR'S RECORD

Section 16

Township 106  
*Des Moines River TWP*

Range 39

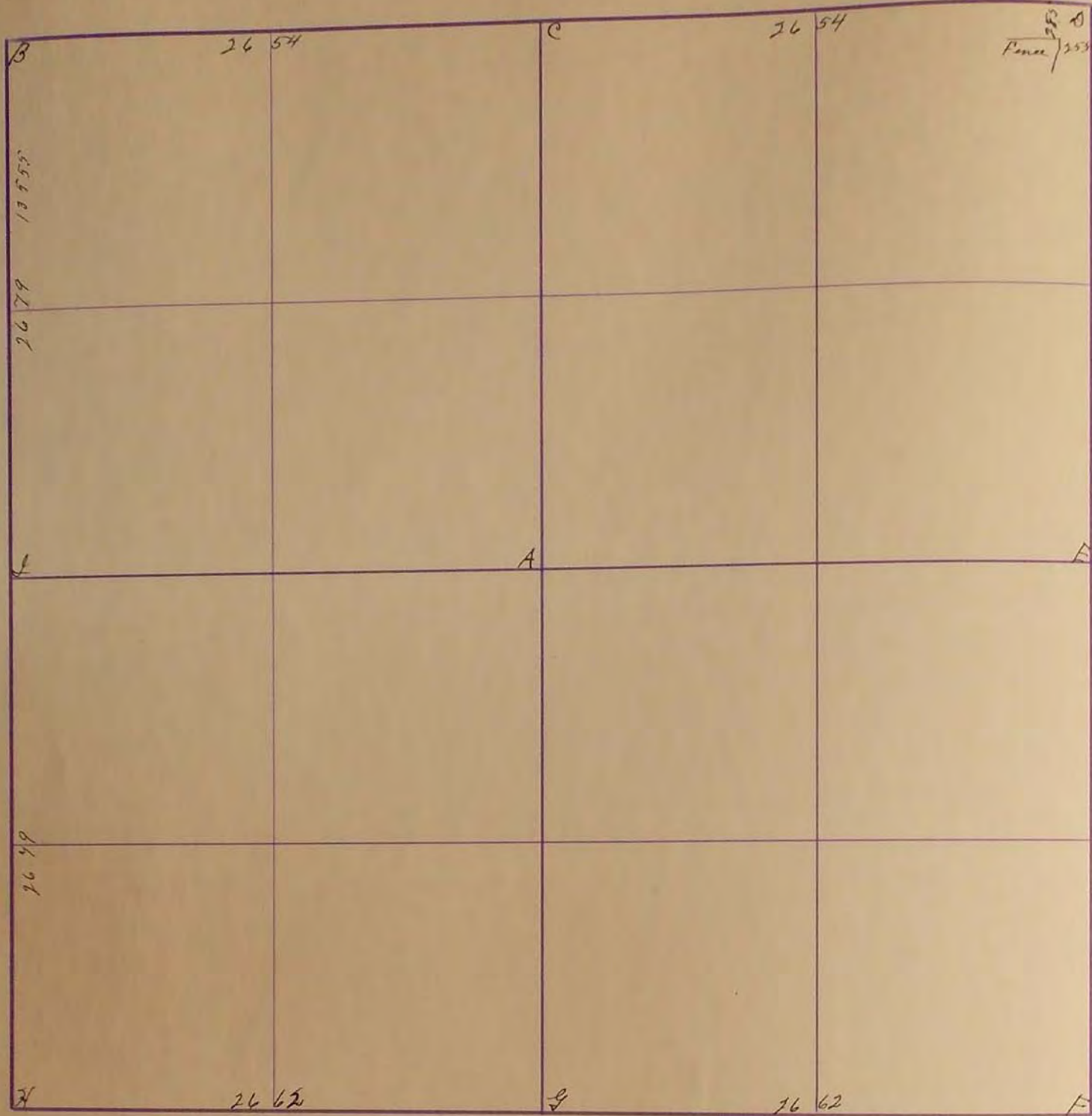

16  
17

June 24-1913

J.H. Hoalstenraft

H. Lel. P. 38' S.W., F. Cor. 43' N.E., F. Cor. 37.5' S.E.

E. Located 1'-6" x 1'-0" Rock 1'-6" below gravel grade 4' East of road  $\frac{1}{2}$ ; Placed steel pin above: R.P., N&C, Brace post S/W 38.50'; R.P., N&C, TP, N/W 52.80'; R.P., Pipe Cor. Post East 32.50' April 10, 1974.

D. Located 12" x 12" field stone 3' below gravel grade; Placed steel pin above: R.P., N&C, P.P. S/E 42.50'; R.P., N&C, corner post S/W 52.15'; R.P., N&C, P.P. Brace pole N/E 46.65'. - April 10, 1974

2712  
Section 16 SURVEY No. 2712  
Town 106 Range 39

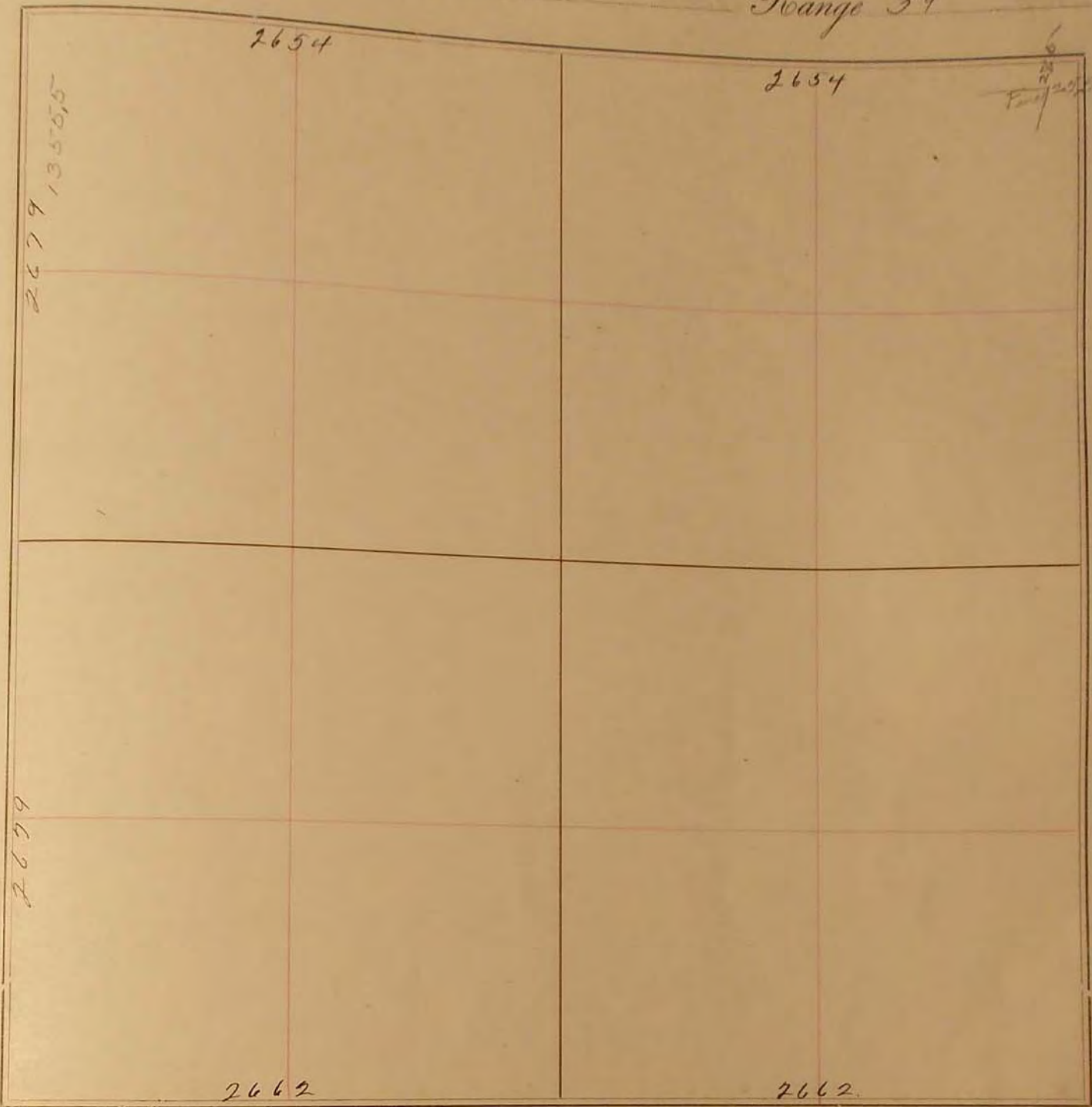

FIELD NOTES.

June 24, 1913

J.W. Woodstewart

H. Td. P. 38' S.W., F. Cor. 43' N.E., F. Cor. 375 S.E.

48  
10